

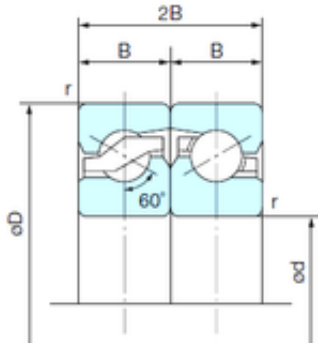

NSK?INDUSTRIA CUSCINETTI S.P.A.

60 mm x 120 mm x 20 mm NACHI 60TAB12DF thrust ball bearings



Bearing No. 60TAB12DF

Size	60x120x20 mm
Bore Diameter	60 mm
Outer Diameter	120 mm
Width	20 mm
d	60 mm
D	120 mm
B	20 mm
C	20 mm
Angle ()	60 °
r min.	1 mm
r1 min.	0.6 mm
2B	40 mm
Weight	1.08 Kg
Basic dynamic load rating (C)	73 kN
Basic static load rating (C0)	137 kN

60TAB12DF Bearing 2D drawings and 3D CAD models