

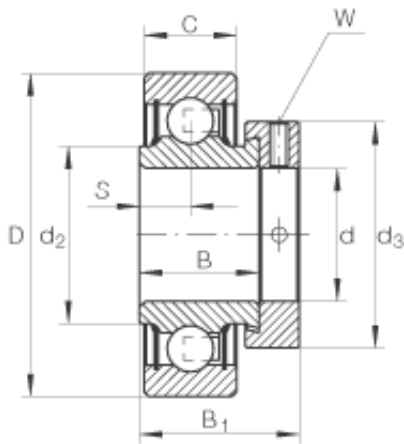

NSK?INDUSTRIA CUSCINETTI S.P.A.



50 mm x 90 mm x 30,2 mm INA RAE50-NPP-FA106 deep groove ball bearings

Bearing No. RAE50-NPP-FA106

RAE50-NPP-FA106 Bearing 2D drawings and 3D CAD models

| | |
|----------------------|--|
| Size | 50x90x43.8 mm |
| Bore Diameter | 50 mm |
| Outer Diameter | 90 mm |
| Width | 43,8 mm |
| d | 50 mm |
| D | 90 mm |
| B ₁ | 43,8 mm |
| B | 30,2 mm |
| C | 22 mm |
| d ₂ | 59,4 mm |
| d _{3 max} | 69 mm |
| S | 11 mm |
| W | 5 mm |
| m | 0,79 kg / Weight |
| C _r | 37500 N / Dynamic load rating (radial) |
| C _{0r} | 23200 N / Static load rating (radial) |
| Category | Insert Bearings Cylindrical OD |
| Inventory | 0.0 |
| Manufacturer Name | SCHAEFFLER GROUP |
| Minimum Buy Quantity | N/A |
| UNSPSC | 31171536 |
| Weight / Kilogram | 0.922 |
| EAN | 4012802787177 |



NSK?INDUSTRIA CUSCINETTI S.P.A.

| | |
|--------------------|--|
| Product Group | M06110 |
| Inner Race Profile | Narrow Inner Ring |
| Outer Race Profile | Cylindrical |
| Mounting Method | Eccentric Collar |
| Rolling Element | Ball Bearing |
| Relubricatable | No |
| Seal Type | Double Lip Contact |
| Snap Ring | No |
| Inch - Metric | Metric |
| Long Description | 50MM Bore; Narrow Inner Ring; 22MM Outer Race Width; 90MM Outside Diameter; Eccentric Collar; Ball Bearing; 43.8MM Length Thru Bore; Not Relubricatable; Double Lip Contact Seal; No Snap Ring |
| Other Features | Single Row Metric |
| Outside Diameter | 3.543 Inch 90 Millimeter |
| Length Thru Bore | 1.724 Inch 43.8 Millimeter |
| Bore | 1.969 Inch 50 Millimeter |
| Outer Race Width | 0.866 Inch 22 Millimeter |